



Super Mini Digital Video Recorder

(SVR-18)

User Manual





CONTENTS

1	GENERAL INFORMATION	4
2	IMPORTANT SAFETY INSTRUCTION	5
3	OPERATING MACHINE	7
4	LIST OF ACCESSORIES	8
5	CABLE INSTRUCTION	9
6	DESCRIPTION BODY PART & BUTTON USAGE	10
7	STARTING DVR	12
8	RECORDING	13
9	VIDEO RECORDING	14
10	RECORDING MODE SETUP	16
11	MP3 FUNCTION	21
12	PLAY MODE SETUP	22
13	VOICE.....	23
14.	DELETE AUDIO FILES	25
15	SETUP	26
16	FILE MANAGER INSTALLATION	30
17	DVR USB INSTALLATION.....	32
18	INSTRUCTION OF SOFTWARE	35



19 DVR SPECIFICATION37



IMPORTANT INFORMATION

Before you use the product, please read and retain the instruction. We do not assume any liability arising out of improper operation.

1 GENERAL INFORMATION

Super-Mini DVR (Digital Video Recorder)

- Portable Media Recorder and Player
- MP3 PLAYER
- VOICE Recorder
- Direct connection to TV via AV cable

DVR contains multimedia features be used in various fields for example creating UCC or industrial areas so on. It is easy to carry and record real situation anytime.

Main Features

- * Support USB. (1.1)
- * Recorded data can be transferred into PC to play.
- * It can play PC media files and MP3 on TV through DVR.
- * Support external memory card - Micro SD card (Up to 1G)

(We do not support Sandisk, please refer to supportable SD card list)

- Transcend
- Kingston
- Digiworks
- Pqi

WARNING

5V adapter is acceptable so please do not connect any other adapter it may cause of serious damage.



2 IMPORTANT SAFETY INSTRUCTION

The important safety instruction ought to be read before operating the product.



Electricity sound or smoke comes from AC adapter, it causes of electric shock and fire. In occasion, please turn off the power and plug out the AC immediately
If AC adapter is broken, the product temperature will increase it cause of damage the product and break down. Plug out the adapter from wall outlet immediately.
Use provided power source. Do not use other power sources it causes of fire or electric shock.
Do not touch AC adapter with wet hand.
Do not unplug the connection cord; take out main body of Adapter.
Do not bend or twist the cable, it causes of fire or electricity shock
Do not load any things on the power; it damages the cord and cause of electricity shock.
Use 110V or 220V only.
Do not use damaged cable, it causes of fire and electricity shock.
For added protection, if there is lighting or storm, please unplug the AC adapter it may be risk of electric shock or serious injury
If there is lighting outside, do not touch and reach to adapter.
Do not use either damaged product or malfunction state, it cause of fire or electricity shock. Unplug the power immediately. Do not try to fix the product yourself.
Please pull out connection cable and unplug when you carry DVR
Do not fall the product and keep children away. It causes of breaking the product.
Do not use the cable inadequate way such rolling neck with cable and do not give to who under 3 years
Do not replace or dismantle the product, it cause of hazard
Do not use in inadequate place or purpose, it causes of damage of product
While carrying the product, please unplug AC adapter.
Do not drop the product
While carrying DVR, be careful with shock. It could be main reason of breaking down
Do not place the product or cable near heat places.
If it is not used for a longer period of time, please unplug the AC adapter for the safety.
Operating Temperature: -5℃ ~ 40℃
Preserving Temperature: -20℃ ~ 60℃



If you do not use for a long period, turn off the DVR and unplug the AC adapter.

When using earphone, do not volume up too high

If the memory card is not ejected correctly, contact technical support immediately. Do not force the card in/out of the slot as this could damage the memory card and or the unit itself.

3 OPERATING MACHINE

Connecting the camera to DVR:

Please turn off the machine and plug in camera to the main body.

If camera is connected with power on DVR, the machine will be off automatically.



Do not plug AV output cable into AV input socket.

If user connect A/V output cable into A/V input socket, it cause of serious damage of product.

Please refer to below cable instruction.

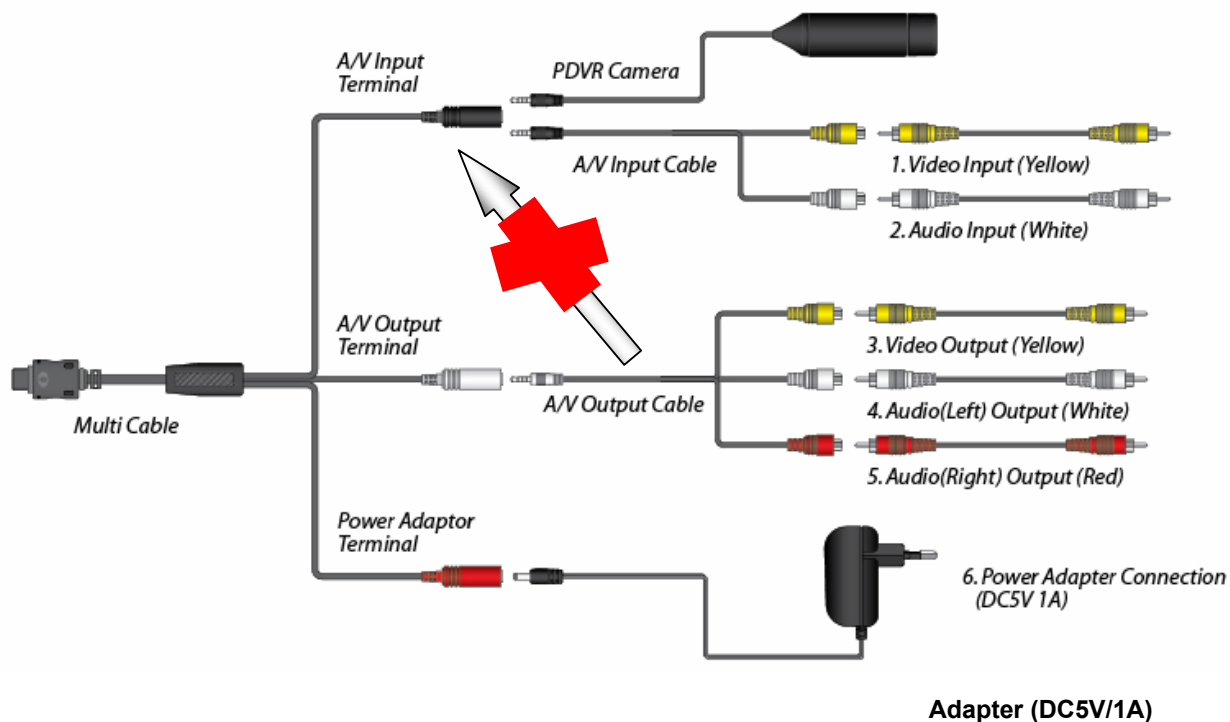

Adapter (DC5V/1A)

4 LIST OF ACCESSORIES

DVR MAIN BODY



DVR CAMERA



CAMERA CABLE



A/V Input Cable



A/V Output Cable



USB CABLE



Adapter (DC5V/1A)



Multi Cable



Earphone(2.5ø)



5 CABLE INSTRUCTION

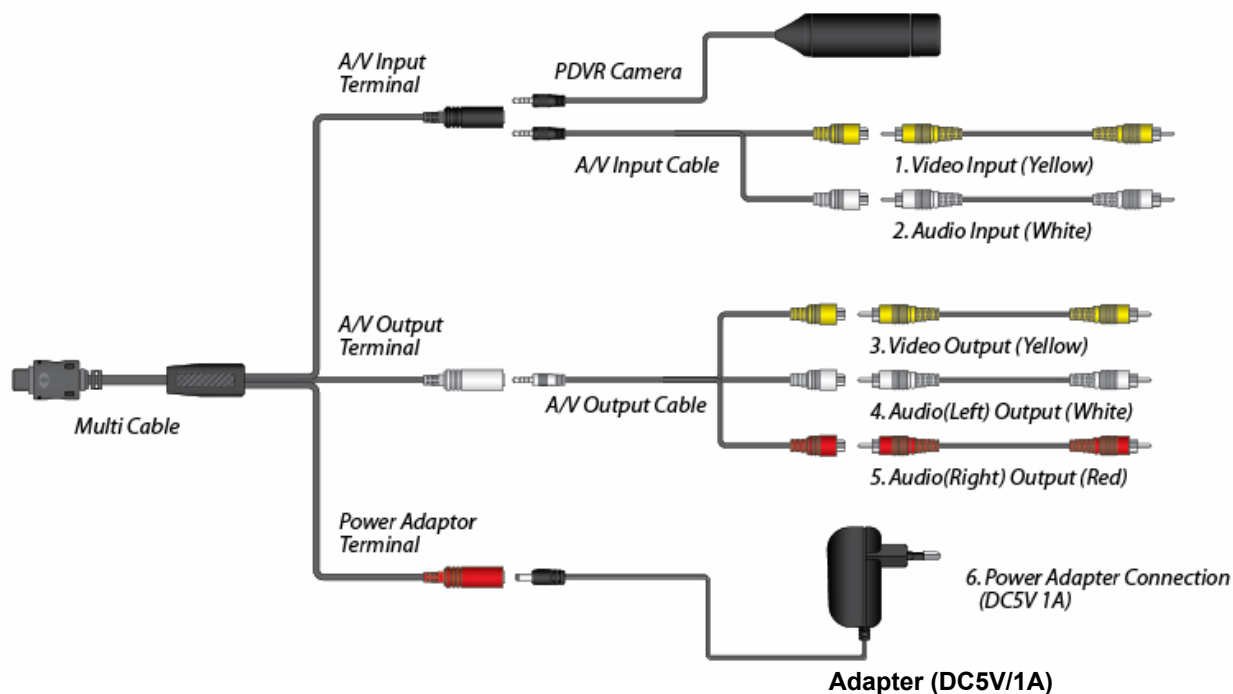

Do not connect higher volt adapters (5V only) to the product, it causes of serious damage to the machine.

USAGE



MP3

When user listen to music, please connect earphone (Ø 2.5).



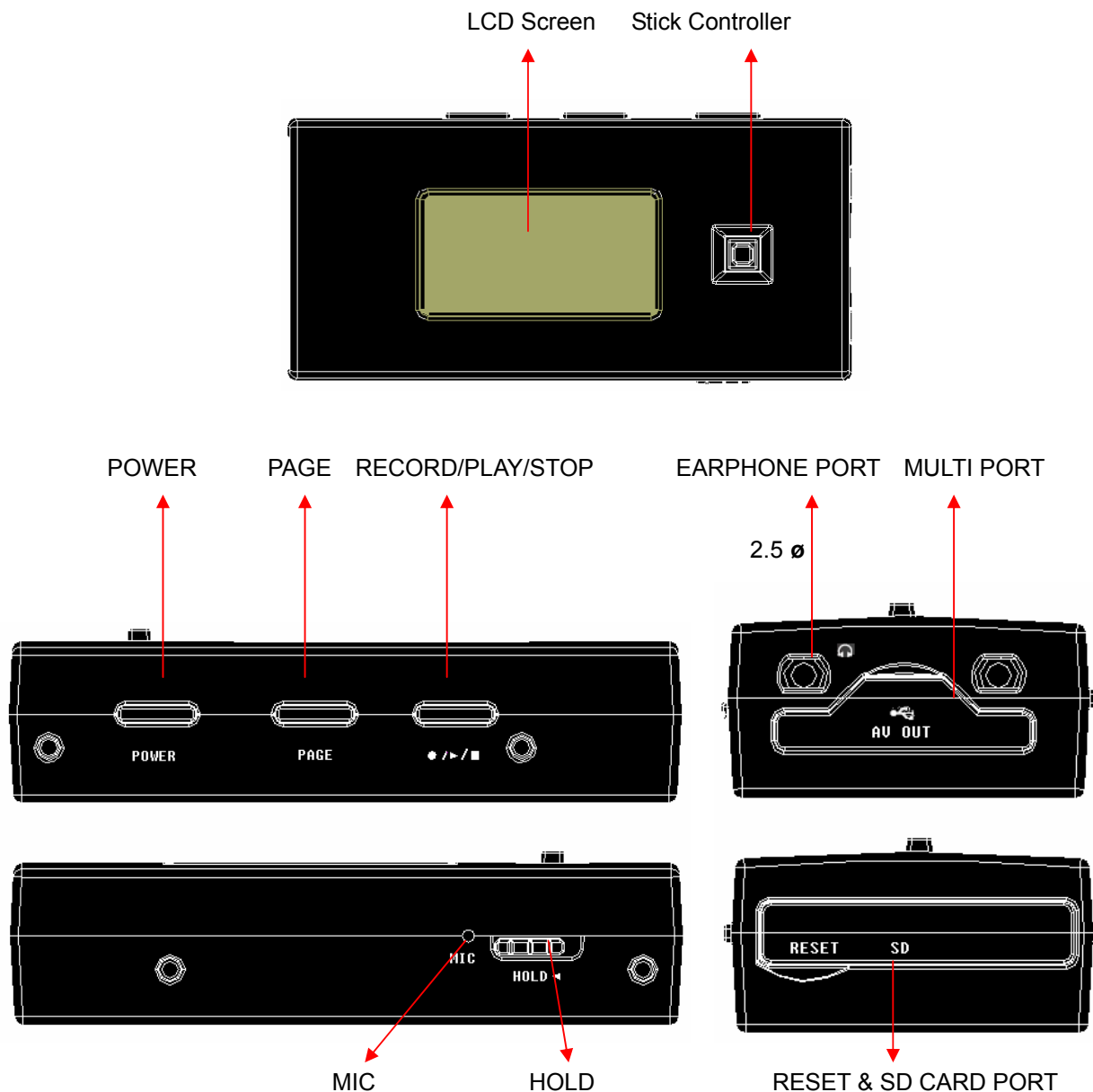

6 DESCRIPTION BODY PART & BUTTON USAGE



RESET FUNCTION

If there is serious matter occur on the product or status of malfunction status, please press "RESET" key on the side of DVR with shape. It will turn off the device with default value.

BUTTON USAGE

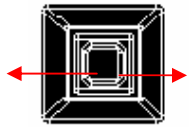
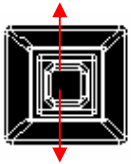
Button	Name	Function
	<i>Power</i>	Turn Off Power (Press the power button for 2~3 seconds to turn ON/OFF)
	<i>Record/Play/Stop</i>	- IN VIDEO PREVIEW MODE <ul style="list-style-type: none"> ➤ Start Recording ➤ Selected file play on the list ➤ VIDEO/MP3/VOICE PLAY MODE ➤ PAUSE <-> PLAY Convert ➤ Select and save on the menu
	<i>PAGE</i>	<ul style="list-style-type: none"> ➤ Move to previous menu (ESC Function) ➤ IN VIDEO/MP3/VOICE PLAY MODE END ➤ Cancel on the menu
	<i>HOLD Setup</i>	HOLD Setup (Lock control button)
	<i>Stick controller lift/right</i>	<ul style="list-style-type: none"> ➤ VIDEO/MP3/VOICE On File List ➤ Internal Memory↔External Memory (SD Card) Convert ➤ In MP3 Mode rewind and fast forward. ➤ Adjust color value
	<i>Stick Controller up/down</i>	<ul style="list-style-type: none"> ➤ Move cursor on the menu ➤ Change the list of song on MP3 mode ➤ Adjust color value

7 STARTING DVR

1) When DVR is on, it shows preview mode

(Input data will be displayed on the screen and if there is no signal, black screen will be on with Time Bar)



2) If user press "PAGE" button on preview mode, it goes to above menu.

3) Press "PAGE" button again, it leads to main menu.

PREVIEW

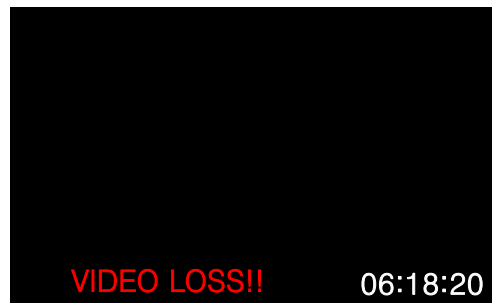

Video Loss message will be shown if there is no camera signal.

8 RECORDING



While recording, if there is no video signal for some reasons, the message will appear on the screen as shown above. Then once the signal is in, it will be restored and record automatically. Moreover, the recording time is indicated on the screen.

NOTE: During the video loss, if there is any functional operation, it would not restore even if the signal is back.

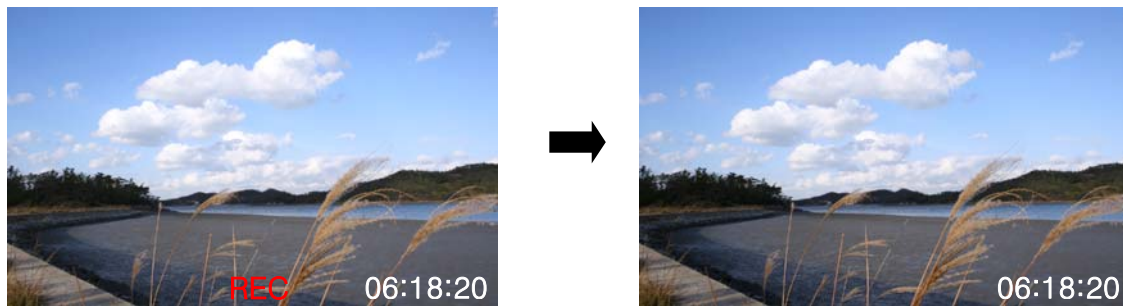

If user clicks the "PLAY" button during recording, it goes to Preview Mode and Recording Mode again.

9 VIDEO RECORDING



- 1) Select menu "START RECORDING" with jog dial or stick controller
- 2) Press "RECORD" button to start recording
- 3) Press 'PAGE" button to stop recording.
- 4) If user press 'PLAY" button in preview mode, it starts recording.

VIDEO FILE LIST

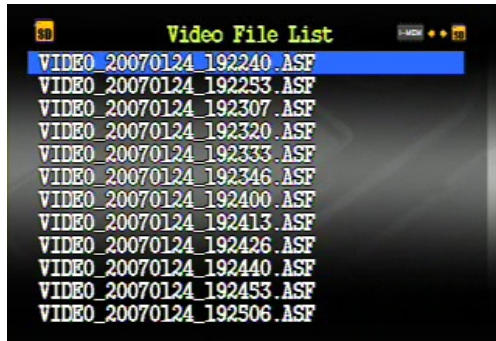

- 1) Enter main menu and go to RECORDING FILE DATA LIST.
- 2) Select a file from on the list and press "PLAY" button.
- 3) Move Stick controller right/left to choose either internal or external memory.
(It is displayed beside battery level)

INTERNAL MEMORY:



EXTERNAL MEMORY:



(SD CARD IN)



(NO SD CARD)



Moreover, DVR provides TV out function therefore; user is able to check the video files via TV and can watch movies which compressed by specific format such AVI so on.



Watch Movie with TV screen

10 RECORDING MODE SETUP



- 1) Go to Recording setup on the main menu

□ RECORDING SETUP->COL SYS SETUP

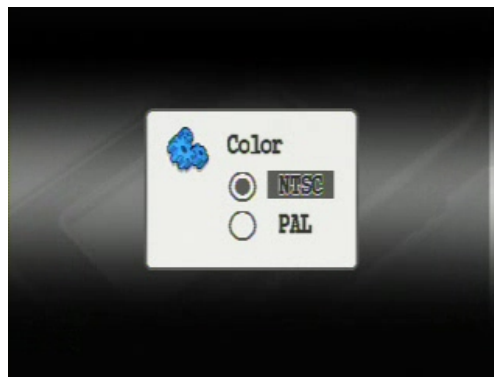

Function: Select VIDEO Output NTSC/PAL.

- 1) With jog dial, go to "COL SYS" and choose VIDEO Output. To apply the setting information, press jog dial or "PLAY" button. Press "PAGE" button to cancel.
(Once the setup is completed, the machine will restart automatically.)



□ RECORDING->RESOLUTION SETUP

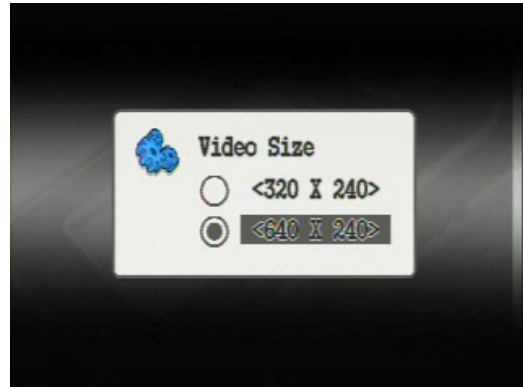
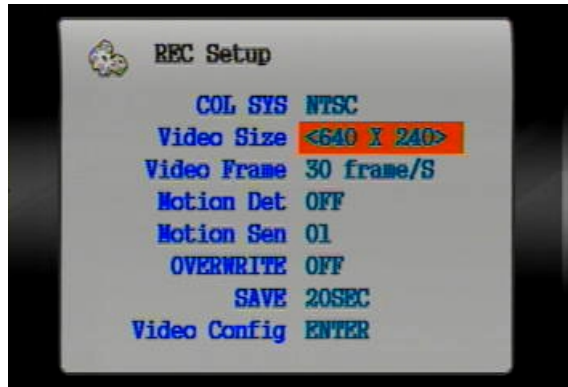

Function: Choose input video resolution

- 1) With jog dial, go to "Resolution" and adjust resolution Up/Down then press "PLAY" button
To apply the setting information, press "PALY" button. For cancel, press "PAGE" button

□ RECORDING SETUP->FRAME SETUP.

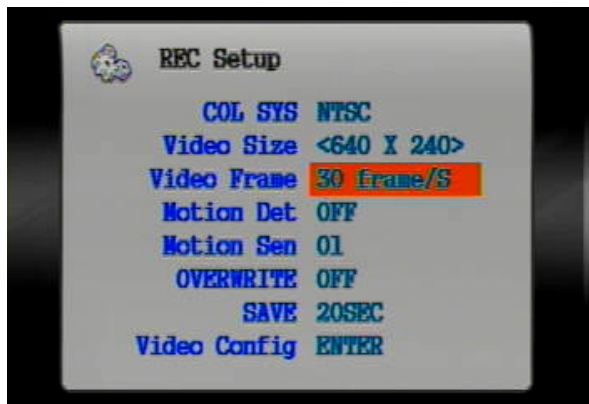

Function Description: Set input frame number.

- 1) Go to "FRAME" section and select the number of Frame then press "PLAY" button to save the setup data.



□ RECORDING SETUP->OVER WRITE SETUP

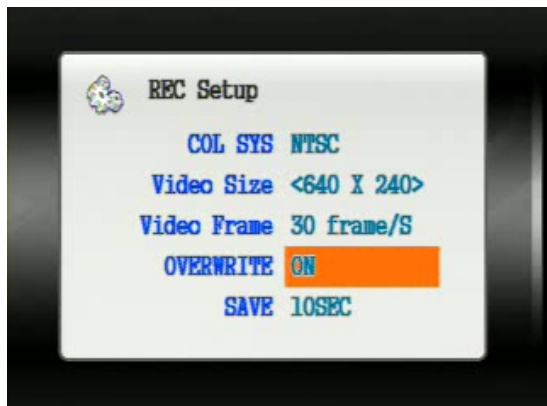

Function description: Overwrite is when the memory is full, it is no longer able to record further data. Choose the option to continue recording with deleting old data.

1) Go to “OVERWRITE” and choose ON/OFF then to apply the setup, press ‘PLAY” button.

NOTE: In Continue Mode, it does not provide OVERWRITE function.

□ RECORDING SETUP-> MOTION DETECTION

There is motion detection function that if user set the function enable, video is recorded if there is moment.



Choose motion detection function On/ Off.



□ RECORDING SETUP → Motion SENSITIVE

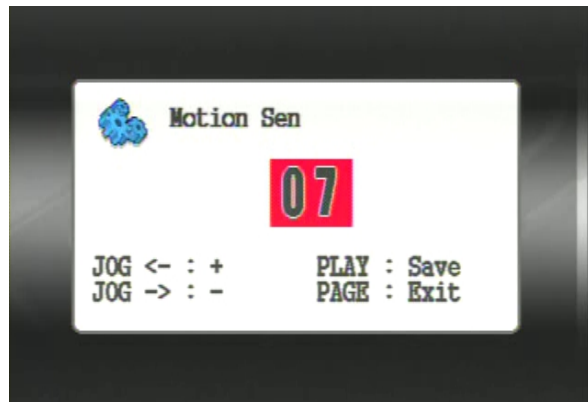

Adjust the sensitive level of Motion Detection.

□ RECORDING SETUP → OVERWRITING

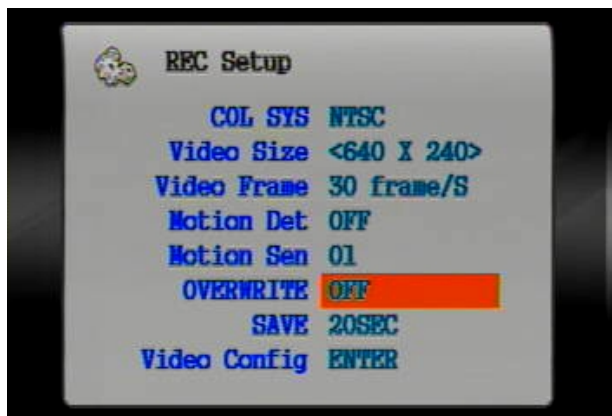

Once user select the option, SD memory card will overwrite automatically deleting old data and save new data.



□ RECORDING SETUP->SAVING SCREEN

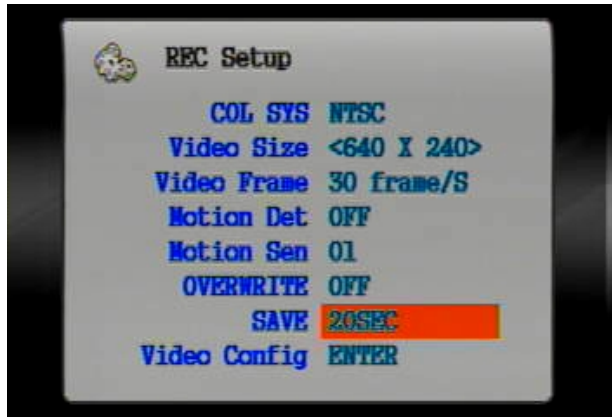

Function Description: the video data can be saved by time period for instance, if user choose 20 seconds, the data will be saved every 20 seconds.

- 1) Go to Screen Saving and select time user wish to save the files then press “PLAY” button to apply.

□ RECORDING SETUP → VIDEO CONFIG

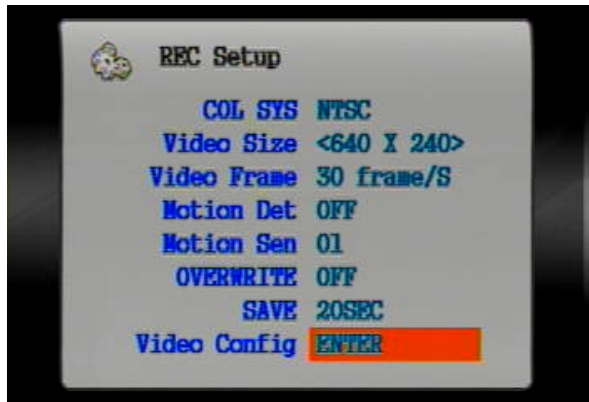

With jog dial, user can adjust the color value Brightness/ Contrast/ Sharpness

11 MP3 FUNCTION

In order to listen to MP3, insert provided earphone or 2.5 ϕ earphone

Go to MP3 mode on the main menu.



MP3 Files List

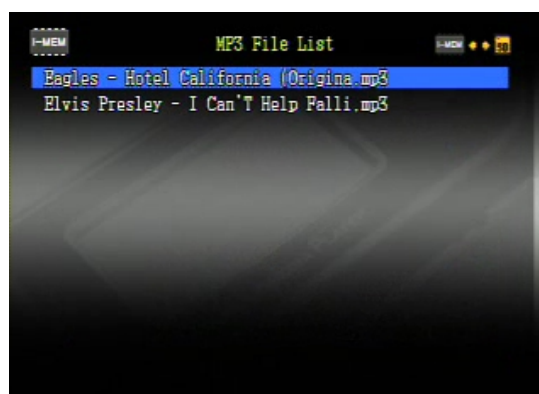
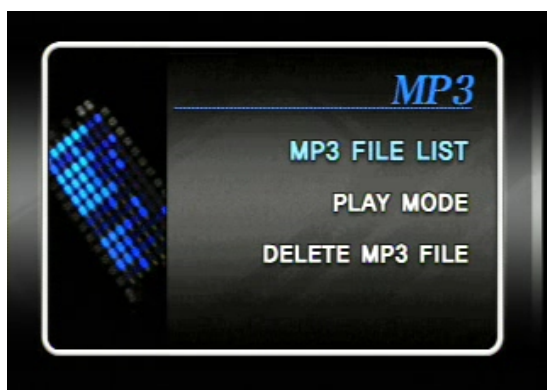

- 1) To play MP3 files, go to MP3 file list and select user wish to listen to.
- 2) Press "PLAY" button to pause.
- 3) Move the joystick right/left to choose internal memory & external memory
(There will be displayed beside Battery mark)

INTERNAL MEMORY:



EXTERNAL MEMORY:



(SD CARD IN)



(NO SD CARD)

12 PLAY MODE SETUP

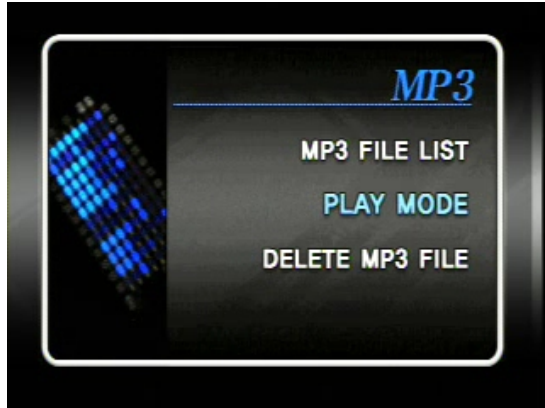

- 1) Choose the option on the main menu and select play mode among "Continue", "Random"
- 2) Selection Button: "PLAY" Cancel: "PAGE"

SELECTED FILE DELETE

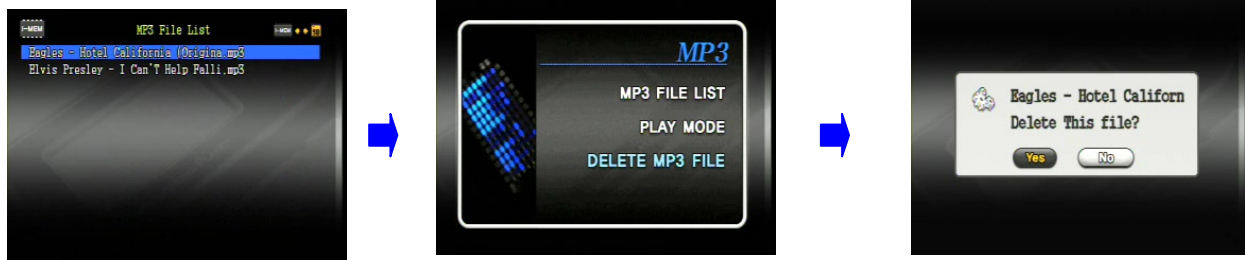

- 1) Choose the file user wish to delete on the list.
- 2) Press "PAGE" key to out from the list/
- 3) Choose "Delete File" then press either "Jog Dial" or "PLAY" button
- 4) To cancel the operation, press "PAGE" button.

13 VOICE



DVR provide Voice Recording which is easily use and convenient to record voice at anywhere. Choose the option on the menu

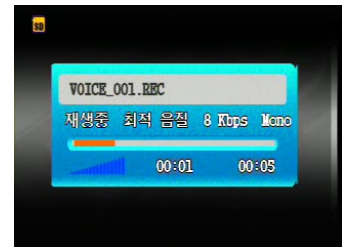

- 1) Select Voice file list and play the files on the list.
- 2) To pause, press "PLAY" button.
- 4) Able to move next file with stick controller.
- 5) Move the joystick right/left to choose internal memory & external memory
(There will be displayed beside Battery mark)



RECORDING MODE

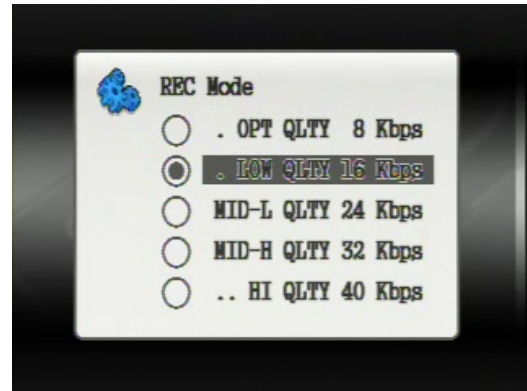

1) Enter Recording Mode in order to select quality of sound.

START RECORD

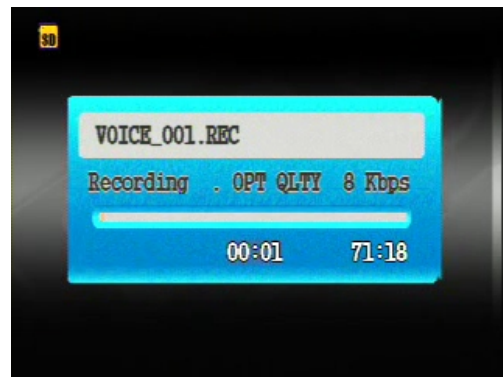

To record voice, simply select “START RECORD” on the menu. Press the “PAGE” button to stop voice recording.

NOTE: The recorded file can be played with this product only. Can't be played on the PC.

14. DELETE AUDIO FILES



To delete audio files, firstly go to the list and select one user want to delete then press "PAGE" button

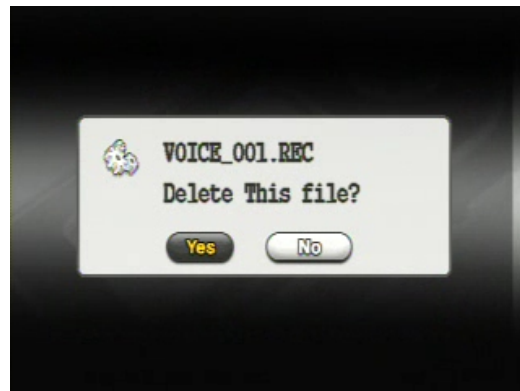

After that go to DELETE FILE and choose "YES" OR "NO"

15 SETUP

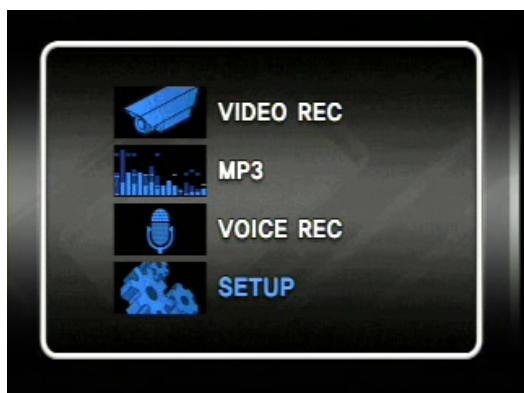

User set the PDVR system its time & date, Back Light, TV out, Language and SD card on the Setup.

□ SETUP->DATE&TIME Setup

Function description: Recorded time and date depend on set up information.

Note: There is no RTC system in the device. Therefore, whenever power on/off user should set the time. When the power off, the last time will be saved then next time user may set from when it was off.

SET TIME & DATE

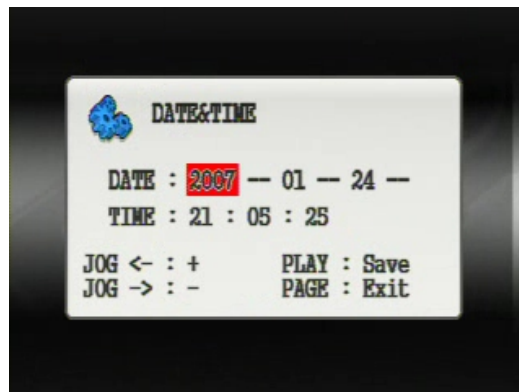
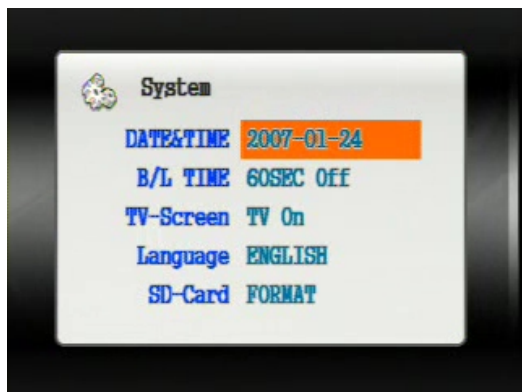

Using the keys which are mentioned on the screen to adjust.



□ SETUP->BACKLIGHT SETUP



Select a time on the list of Back light

□ SETUP->TV SCREEN SETUP

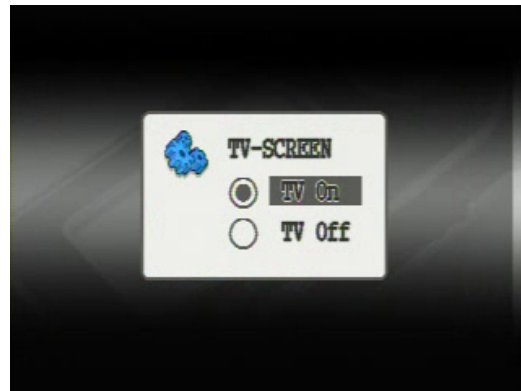
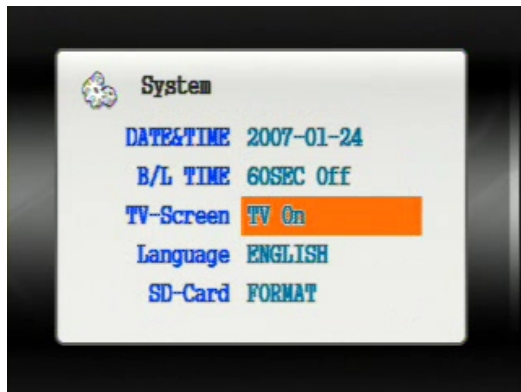

Function Description: TV out function.

If user choose "TV ON", able to see the video data on the TV screen.



□ SETUP->LANGUAGE SETUP

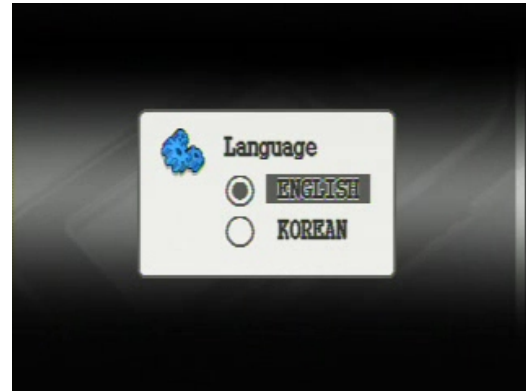
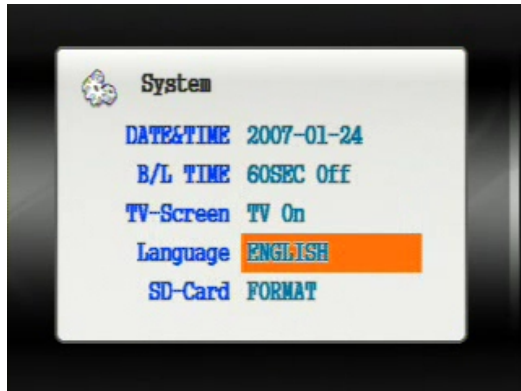

Select language which display on the TV screen and LED screen on the surface.
Once the setup is completed, the system reboots up automatically to apply



□ SETUP->SD-Card FORMAT

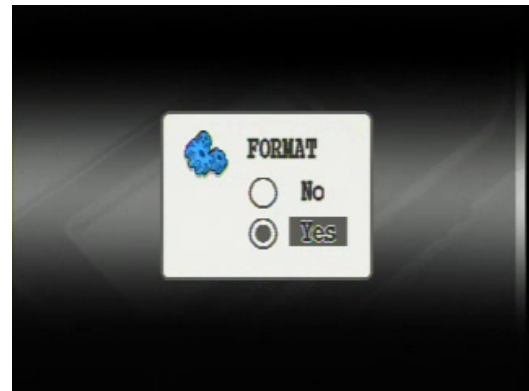
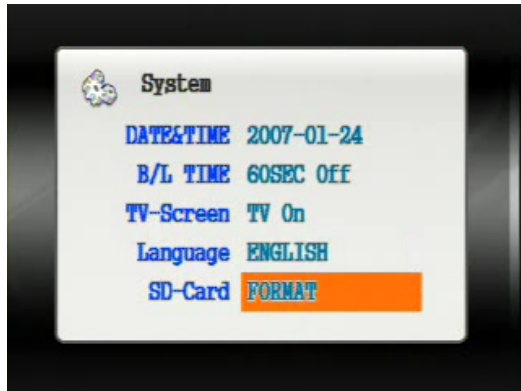

Format the SD card to be default value.

Format processing

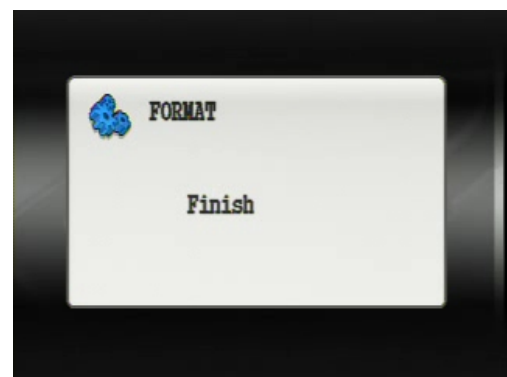

16 FILE MANAGER INSTALLATION

In order to install the program, run the SETUP.EXE

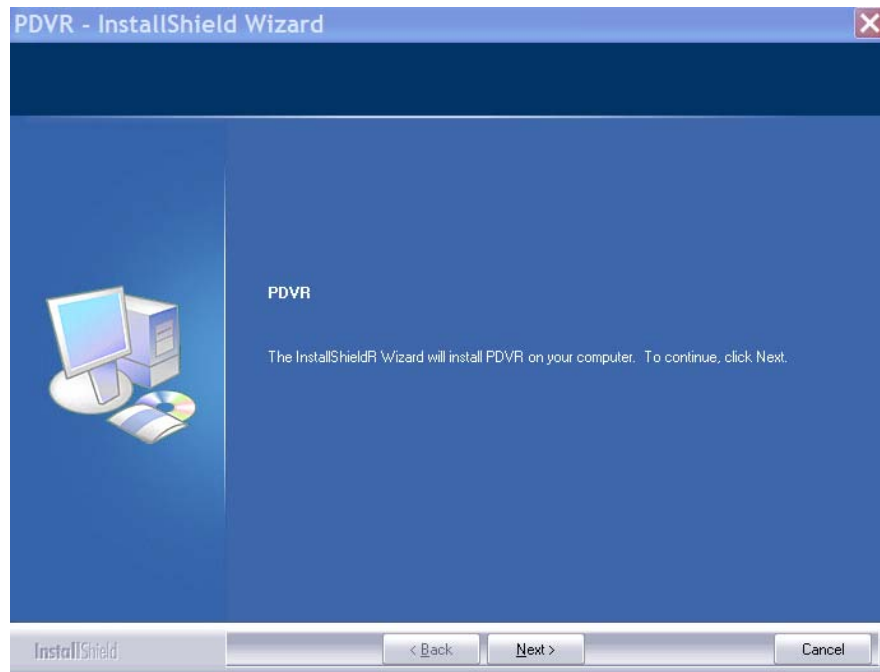

Click "NEXT" to continue

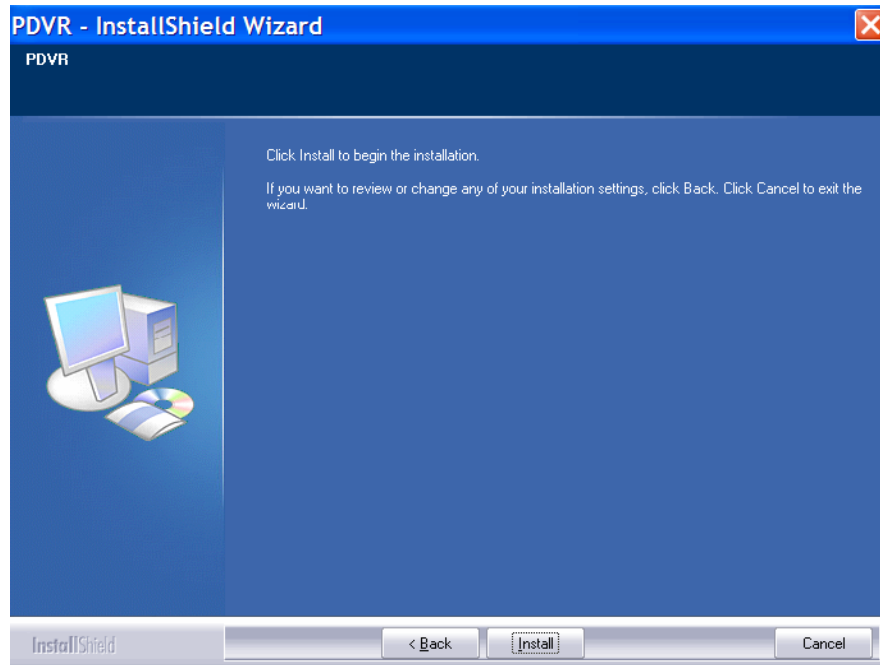

To continue the installation, click "INSTALL"



After installation, there will be operating ICON on the desktop



Click the ICON to implement the DVR software

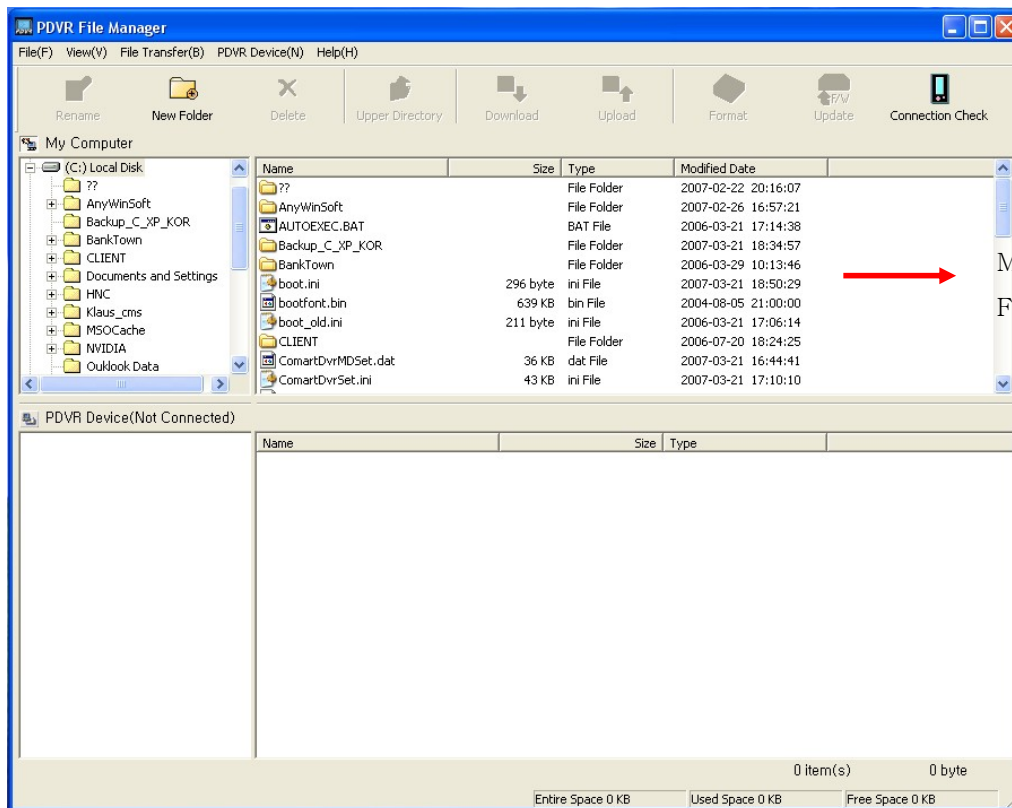

Main screen of DVR File Manager

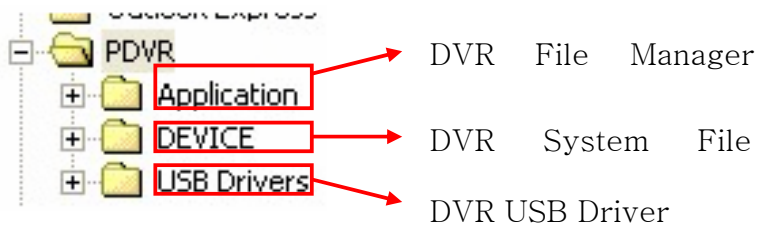

There is above folder in the directory.

17 DVR USB INSTALLATION

To update firmware or connect with PC to transfer information, USB driver install is required.

Connect DVR with PC and turn on the device then below message will appear.



Select second option "Install from a list or specific location" then click NEXT

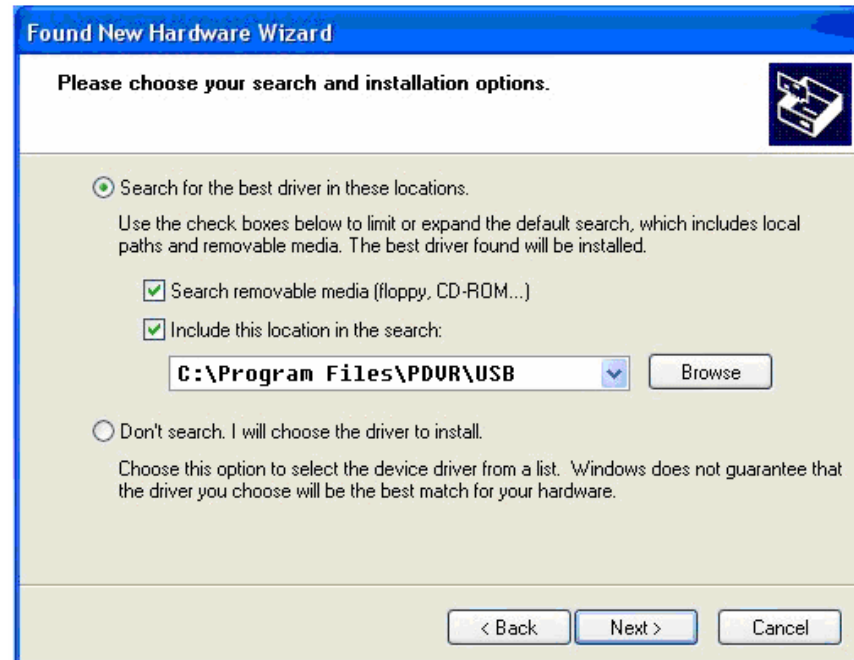



Check the “Include this location in the search” then browse.

Go to (C:\Program File\PDVR\USB driver)



Then click “NEXT” it will start look for the driver.



Click “Continue Anyway”

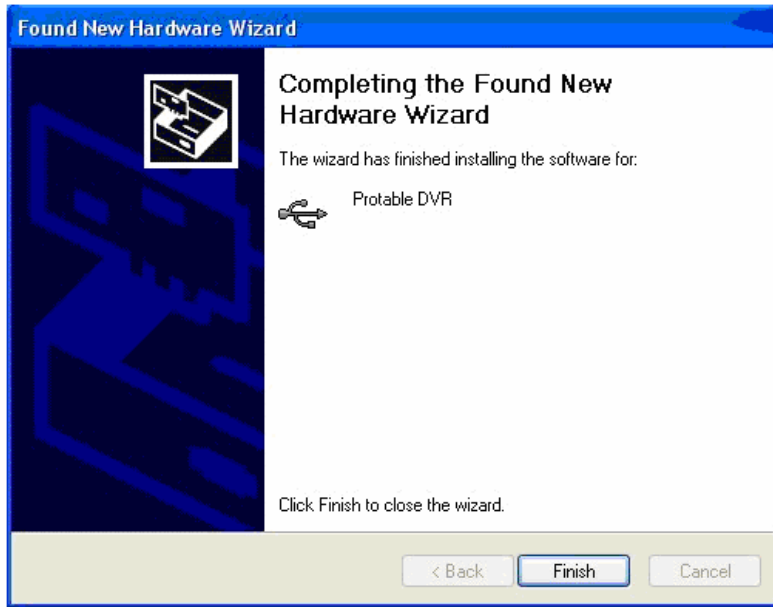

The driver installation is completed.

To check whether the installation is completed properly, go to “Device Manager”

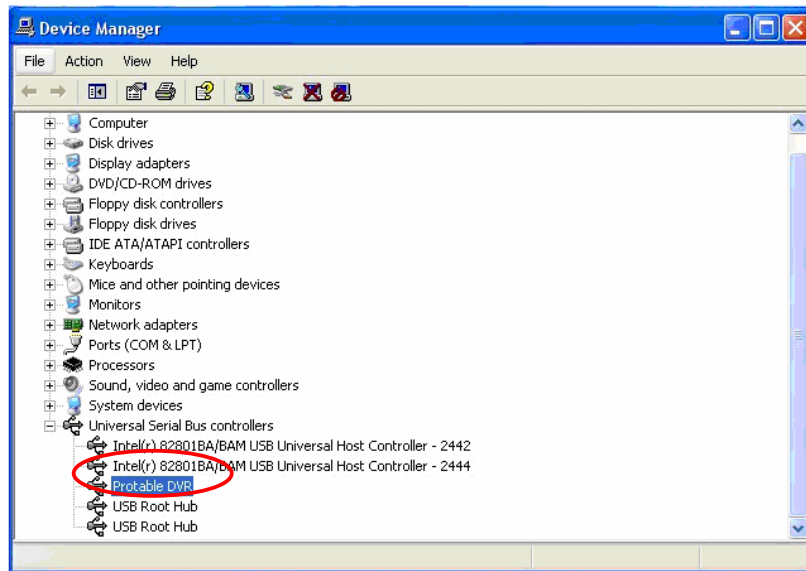

There is DVR section on the Universal Serial Bus Controllers.

18 INSTRUCTION OF SOFTWARE

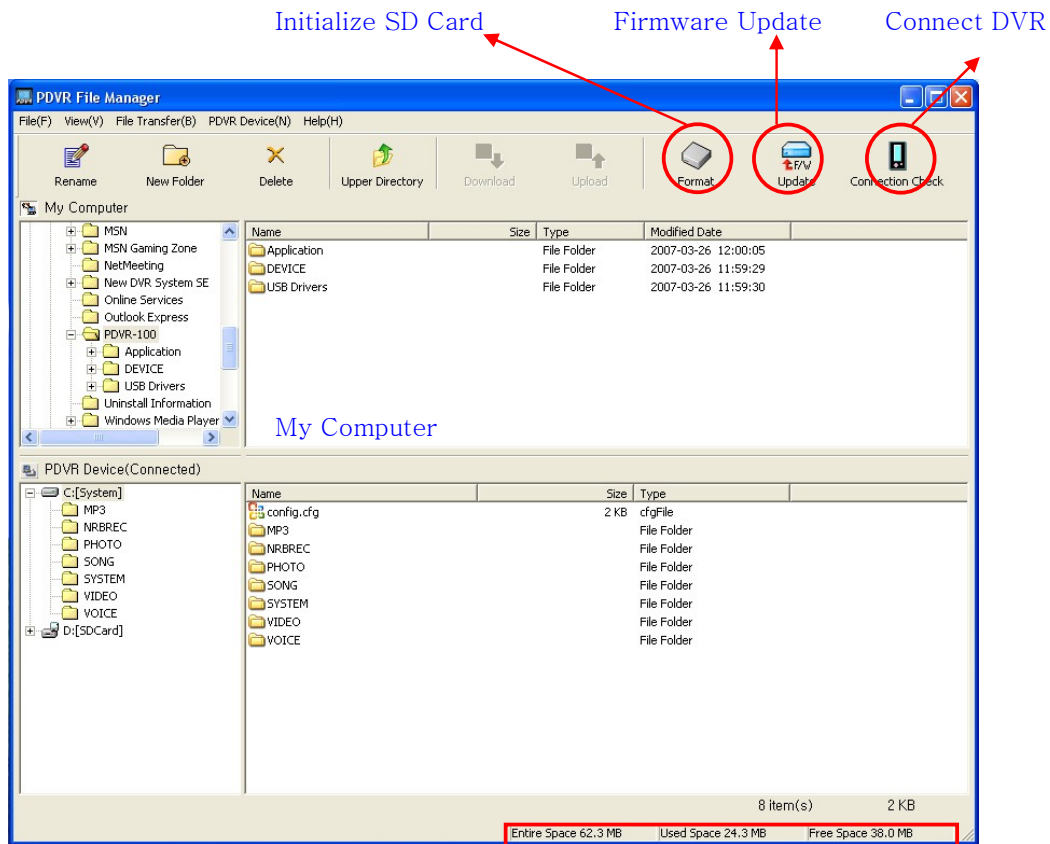

DVR general Information

Once the installation is finished above DVR window pop up on the screen.

To transfer the files or information from My Computer to DVR

Choose files on the screen then the download key will be activated.

To transfer the files to Computer from DVR to My Computer

Choose folder to save the files and click the files user wish to transfer. Afterward, the key will be enabled then click it to transfer the information.

Note: Do not disconnect the USB while the data is transferred otherwise this may cause losses of data.



In case of eliminated all the system files.

If system file is gone, then the device would not work properly so if the happen come up, do not hesitate. To recover the system, go to DVR Folder and find out System Folder which contain exact same files in case of accidents. Copy the files and drop it in our file folder.

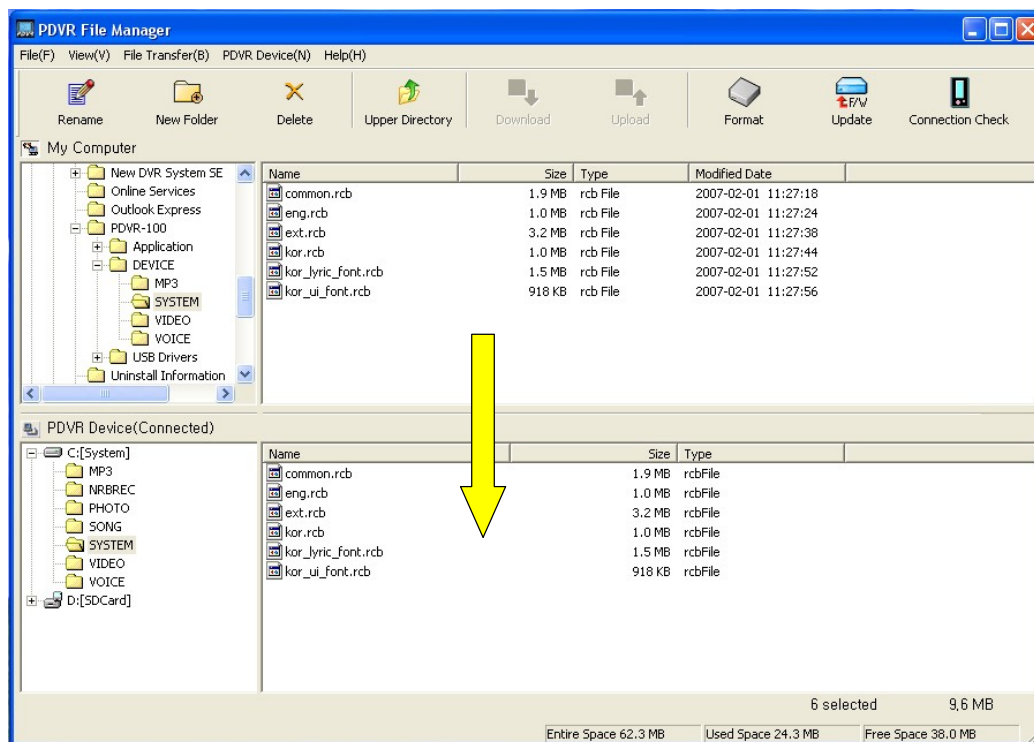

Simply copy and drop on the PDVR system

When user transfers any information such a Music or Movie, these should be placed on right folders.



19 DVR SPECIFICATION

DVR

TYPE	DEVICE SPECIFICATION		
VIDEO RECORD MODE	Video Format		
	NTSC/PAL		
	VIDEO	Format	MPEG4 SIMPLEX
		Frame Rate	1~30fps
		Encoding Resolution	320x240, 640x240
	Overwrite		YES
	Saving Time		10/20/30/60/300 sec and Continuous
	Support File Format		ASF FORMAT
	Audio Codec		G726, Bit rate(32kbps), sampling rate(8khz)
Recording Time		Approximately 2 hours	
PLAY VIDEO MODE	VIDEO	Decoding Resolution	720x480
		Format	MPEG4 Simplex
	AUDIO	Codec	MPEG 1/2/2.4 Layer3, G726
		Bit Rate	8Kbps ~ 192Kbps
	Support File Format		ASF, AVI Format
AV Input	Video Mode	Input voltage : 1Vpp Supported Type : NTSC / PAL	
	Audio Mode	Input Voltage: MAX 1Vpp	
VOICE RECORDNG G729	Record Bit Rate	Sampling rate 8Khz 16Kbps-24-32-40Kbps	
POWER	Electricity	DC 5V 1A	
OPERATION ENVIRONMENT	IBM-PC	Window 2000, XP	
	Interface	USB 1.1	
	Storage Format	Max 1GB T-Flash Card	



CAMERA SPECIFICATION

Model Name	Super Mini DVR	
Image Sensor	1/4" SONY SUPER HAD (270K pixels)	
H. Resolution	NTSC - 380TVL	PAL - 380TVL
Scanning System	525TVL, 60 Field/Sec(NTSC)	625TVL, 50 Field/Sec(PAL)
Effective Pixels	NTSC : 510 (H) x 492 (V)	PAL : 500 (H) x 582 (V)
Min. Illumination	0.3Lux (IR LED Off)	
Video output Level	1.0Vp-p (75ohms, Composite)	
S/N Ratio	More than 50dB (AGC Off)	
Gamma	$r = 0.45$	
Sutter Speed	Auto 1/60~1/100,000sec	Auto 1/50~1/100,000sec
White Balance	Auto White Balance	
Gain Control	4dB - 32dB - Auto	
Operating Humidity	- 20℃ - +50℃ (10% - 95% RH)	
Lens	STD Lens : f = 3.6mm Lens	
Power Source	DC3V 220mA	
AUDIO	With AUDIO	
Dimensions	18Ø(mm)x74(mm)	
Net Weight	100g	